

Upper Level

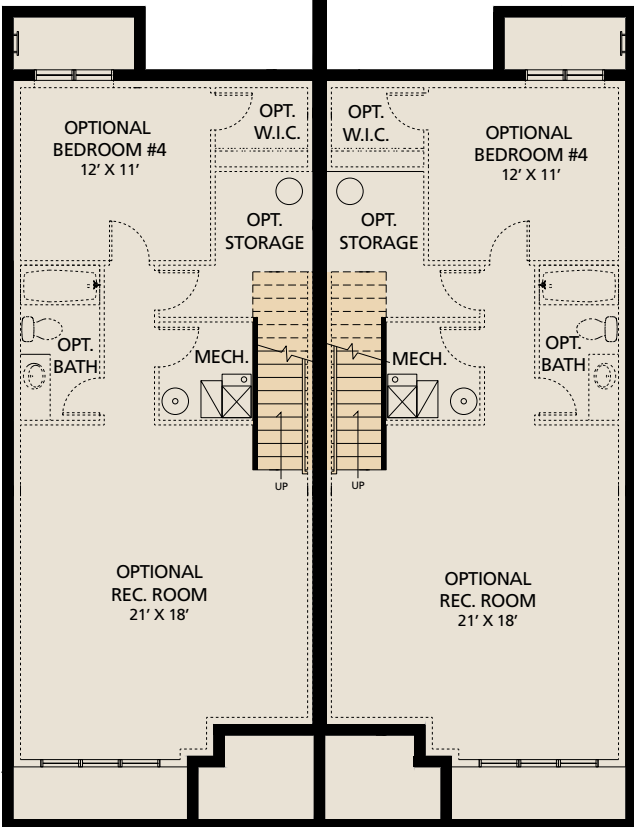

Unfinished Lower Level

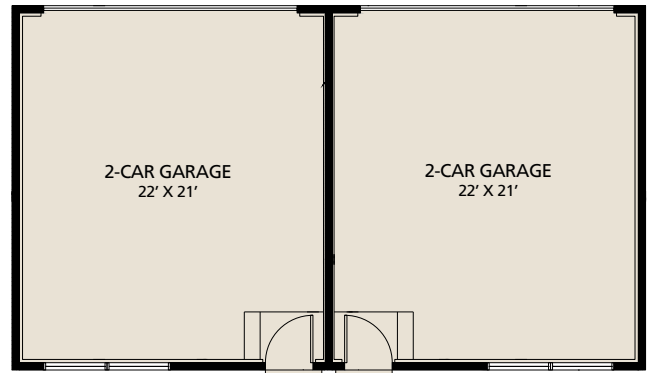

Garage

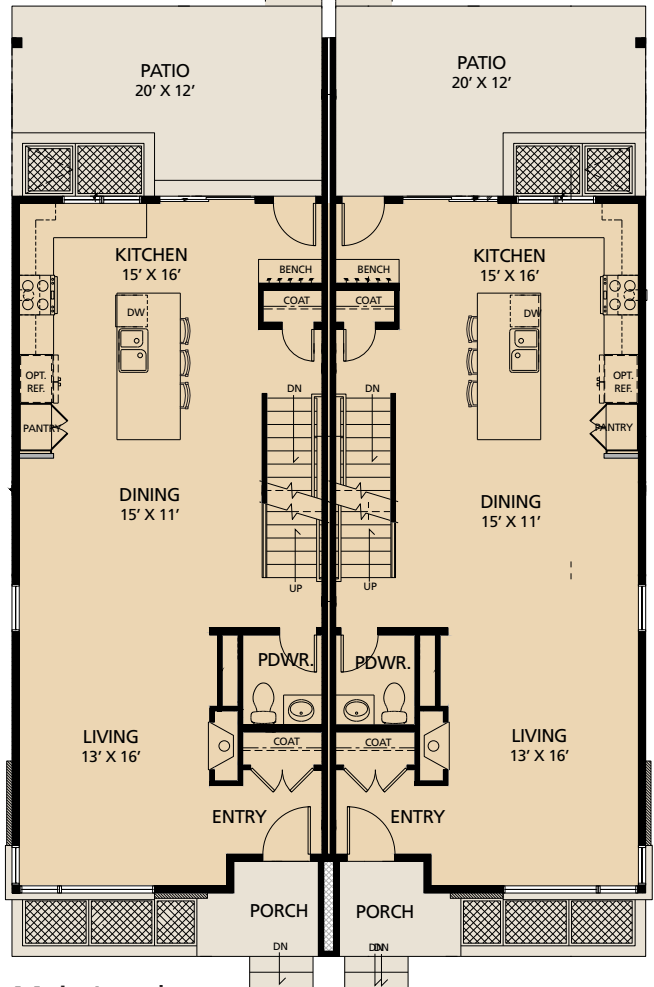

Main Level

### Duplex Living

Markel Homes at  
**PROSPECT**  
 new town

Upper Level.....	1,015 sq. ft.
Main Level.....	868 sq. ft.
Lower Level Finished .....	63 sq. ft.
Total Finished .....	1,946 sq. ft.
Lower Level Unfinished....	732 sq. ft.
Total .....	2,678 sq. ft.
Opt. Lower Level Finish ..	699 sq. ft.

We reserve the right to modify or change plans, specifications, features and prices without notice. Renderings are artist's concepts.

Custom-designed duplexes on the park



MarkelHomes at

PROSPECT

new town

## Duplex Living

**PROMINENT GLASS, THE FLAT ROOF AND CONTEMPORARY ARCHITECTURAL LINES** spell star power for the duplexes created for the bold and pleasing streetscape in Prospect New Town. Huge front-facing windows in the living area and in the upper level master suite accentuate the feel of interior spaciousness. Each home enjoys three exterior walls with windows throughout and two skylights over the staircase, flooding the interior in natural light. A large rectangular island draws the eye to the cooking and dining areas in the completely open and inviting main floor. Cooks love the high-end finishes in the kitchen, including solid surface countertops, stainless steel appliances and great-looking quality cabinetry. The master suite and nearby laundry room occupy the front half of the upper level, with two additional bedrooms and a full bath with dual-sink vanity. Opt for the lower level finish and add more living and sleeping quarters plus a third bath and storage room.

- Courtyard and large partially-covered patio add an intimate ambience to the outdoor living area between the two-car detached garage and the house.
- Fireplace and huge windows on the park create a welcoming vibe as you enter the home.
- Large island is ideal for light meals, catching up on emails and entertaining family and friends.
- High-style kitchen features quality cabinetry, solid surface countertops, stainless steel appliances, gas range and under-mount Kohler® sink.
- Enjoy gleaming hardwood floors on the main level and tile in the baths and laundry room.
- Luxury master bath features a soaking tub with window above, dual-sink vanity, large shower with bench seat and an enclosed toilet.
- Convenient coat closet and powder room are located near the front entry.
- Handy built-in bench with wall hooks and a coat closet are located at the back entry.
- Relish the low-maintenance and lock 'n leave *easy living* convenience of the duplex lifestyle in this original and well-loved New Urbanist neighborhood.

 **MarkelHomes.com**

