

Unit A

Upper Level.....	964 sq. ft.
Main Level.....	667 sq. ft.
Lower Level.....	59 sq. ft.
Total Finished.....	1,690 sq. ft.
Unfinished Lower Level..	549 sq. ft.
Total.....	2,239 sq. ft.

Unit B

Upper Level.....	968 sq. ft.
Main Level.....	667 sq. ft.
Lower Level.....	59 sq. ft.
Total Finished.....	1,694 sq. ft.
Unfinished Lower Level..	549 sq. ft.
Total.....	2,243 sq. ft..

We reserve the right to modify or change plans, specifications, features and prices without notice. Renderings are artist's concept.

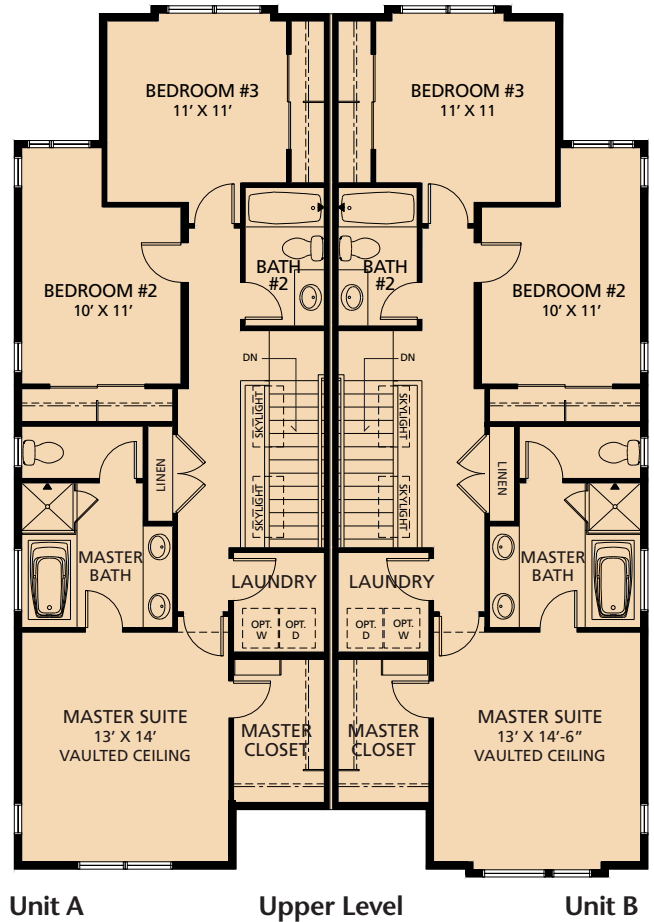

Unit A

Upper Level

Unit B



Duplex Living

SAY GOODBYE TO LAWN CARE AND SNOW REMOVAL with a stylish, well-built *easy living* duplex. You're close to North End's multi-use path, Hecla lake Open Space, and a link to the area's vast trail network. Step from the private front porch into an open and inviting main floor featuring living, dining and kitchen areas. Large windows across the front and along the exterior wall as well as two upper level skylights allow beautiful natural light throughout the day. More windows and a vaulted ceiling create a spacious feel in the master suite, with five-piece bath and walk-in closet. Bedrooms two and three share the second full bath. Finish the lower level now or down the road and add a third bath and media room, home office or yoga and exercise area.

- Efficient U-shaped kitchen featuring solid surface counter tops, gas range, two double-door pantry cabinets and breakfast bar with seating for three.
- Two large skylights above the staircase that flood the interior in natural light.
- Covered front porch and private entrance, handy coat closet, and main floor powder room.
- Gorgeous and durable hardwood flooring in the living, dining and kitchen areas, with tile in the baths and laundry room.
- Contemporary five-piece master bath with dual-sink vanity, soaking tub below a window, enclosed shower, and water closet with window.
- Convenient linen closet and laundry room near the bedrooms on the upper level.
- Great-looking, bold **new**west architecture featuring a variety of materials, metal accents and large-paned, prominent windows plus attached two-car garage.
- Exterior maintenance, snow removal and landscaping services covered by HOA fees.
- Minutes from the Main Street food and music scene in downtown Louisville.

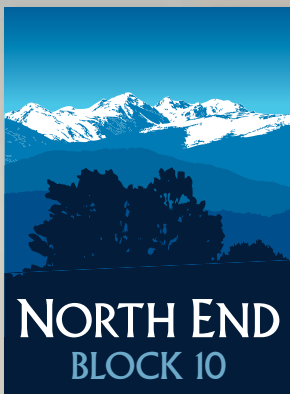

NORTH END
BLOCK 10

Michele Steward
303-604-9196

Michele@MarkelHomes.com